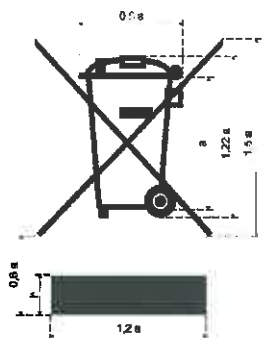

<b>Prüfbericht - Nr.: 143162388a 001</b>		Seite 1 von 7 Page 1 of 7	
<i>Test Report No.:</i>			
<b>Auftraggeber:</b>		<b>Scapequest Pty Ltd Tradingas Battlefield Sports</b>	
<i>Client:</i>		Unit 1, 6 Graham Street, Underwood, Brisbane, Queensland	
<b>Gegenstand der Prüfung: Toy Gun</b>			
<i>Test Item:</i>			
<b>Bezeichnung:</b>	COBRA	<b>Serien-Nr.:</b>	Engineering Sample
<i>Identification:</i>		<i>Serial No.:</i>	
<b>Wareneingangs-Nr.:</b>	00110307074	<b>Eingangsdatum:</b>	07.03.2011
<i>Receipt No.:</i>		<i>Date of Receipt:</i>	
<b>Prüfört:</b>	<b>TÜV Rheinland Hong Kong Ltd.</b>		
<i>Testing Location:</i>	9-10/Floor, Emperor International Square, 7 Wang Tai Road, Kowloon Bay, Kowloon, Hong Kong		
<b>Prüfgrundlage:</b>	<b>Directive 2002/96/EC</b>		
<i>Test Specification:</i>	<b>Article 4, 10 and 11</b>		
	<b>EN 50419:2006</b>		
<b>Prüfergebnis:</b>	<b>Der Prüfgegenstand entspricht oben genannter Prüfgrundlage(n).</b>		
<i>Test Result:</i>	<i>The test item passed the test specification(s).</i>		
<b>Prüflaboratorium:</b>	<b>TÜV Rheinland Hong Kong Ltd</b>		
<i>Testing Laboratory:</i>			
<b>geprüft / tested by:</b>		<b>kontrolliert / reviewed by:</b>	
16.06.2011	Nicky Leung / Project Engineer	16.06.2011	Steve Kwok / Reviewer
<i>Datum</i>	<i>Name/Stellung</i>	<i>Unterschrift</i>	<i>Unterschrift</i>
<i>Date</i>	<i>Name/Position</i>	<i>Signature</i>	<i>Signature</i>
<b>Sonstiges / Other Aspects:</b>			
<ul style="list-style-type: none"> <li>- attached 1 page of appendix 1</li> <li>- attached 3 pages of appendix 2</li> </ul>			
<b>Abkürzungen:</b>	<i>P(ass)</i> = entspricht Prüfgrundlage	<b>Abbreviations:</b>	<i>P(ass)</i> = passed
	<i>F(ail)</i> = entspricht nicht Prüfgrundlage		<i>F(ail)</i> = failed
	<i>N/A</i> = nicht anwendbar		<i>N/A</i> = not applicable
	<i>N/T</i> = nicht getestet		<i>N/T</i> = not tested
<p><b>Dieser Prüfbericht bezieht sich nur auf das o.g. Prüfmuster und darf ohne Genehmigung der Prüfstelle nicht auszugsweise vervielfältigt werden. Dieser Bericht berechtigt nicht zur Verwendung eines Prüfzeichens.</b></p> <p><i>This test report relates to the a. m. test sample. Without permission of the test center this test report is not permitted to be duplicated in extracts. This test report does not entitle to carry any safety mark on this or similar products.</i></p>			

Prüfbericht - Nr.: <b>1431622388a 001</b>		Seite 2 von 7 Page 2 of 7	
Clause	Requirement	Remark	Verdict
1	<b>Marking according to article 11(2) 2002/96/EC</b>		
1.1	<b>Requirements according to EN 50419:2006</b>		
1.1.1	Unique Identification of producer provided e.g. by brand name, trade mark, address of manufacturer etc.	<input checked="" type="checkbox"/> Brand Name <input type="checkbox"/> Trademark <input checked="" type="checkbox"/> Other identification <input type="checkbox"/> No identification	P
1.1.2	Date or year of manufacture/placed on the market provided (coded or un-coded text according to ISO 8601:2004) or indicated by the additional bar	<input type="checkbox"/> Coded or encoded text <input checked="" type="checkbox"/> Additional bar <input type="checkbox"/> No date / additional bar	P*
1.1.3	Marking and dimensions of marking as outlined in standard EN 50419:2006 Size of marking:  Minimum value of a = 3.33mm Minimum height of bar = 1mm Minimum height of whole symbol = 7mm Minimum height of cross-out wheel bin symbol = 5mm	<input type="checkbox"/> Marked, correct dimension <input type="checkbox"/> Marked, incorrect dimension <input type="checkbox"/> Not marked Height of bar: minimum 1mm Height of whole symbol: minimum 7mm Height of cross-out wheel bin symbol: minimum 5mm value of a: minimum 3.33mm	N*
1.1.4	The marking shall be visible, legible and indelible. Marking durability: Inspection and by rubbing by hand for 15s with a piece of cloth soaked with water and again for 15s with a piece of cloth soaked with petroleum spirit.	Type of marking: <input checked="" type="checkbox"/> Molding <input type="checkbox"/> Label <input checked="" type="checkbox"/> Printing Marking is: <input checked="" type="checkbox"/> visible <input checked="" type="checkbox"/> legible <input checked="" type="checkbox"/> indelible	P*

Prüfbericht - Nr.: Test Report No.:		1431622388a 001		Seite 3 von 7 Page 3 of 7	
Clause	Requirement	Remark	Verdict		
1	<b>Marking according to article 11(2) 2002/96/EC</b>				
1.1.5	<b>Location of marking:</b> The marking shall be applied: a) on the product, or b) on the packaging, in the instructions for use and in the warranty of the electrical and electronic equipment.	<input checked="" type="checkbox"/> Moulded on product <input type="checkbox"/> Label on product <input checked="" type="checkbox"/> Printed on product <input checked="" type="checkbox"/> Packaging, instructions for use and warranty <input type="checkbox"/> None of the above	P*		
1.1.6	<b>Visibility of marking on the product:</b> The marking shall be visible but if necessary after removal of a cover. For portable products it shall be possible to remove or open this cover without the aid of a tool, unless health and safety reasons as defined in other directives or standards require that a tool is needed to remove the cover.	<input checked="" type="checkbox"/> Visible without removing/opening the cover (or product without cover) <input type="checkbox"/> Visible after removal of a cover <input type="checkbox"/> Not portable product <input type="checkbox"/> Portable product, it is possible to remove or open the cover without the aid of a tool <input type="checkbox"/> Portable product, a tool is needed to remove the cover as defined in other directives or standards for health or safety reason <input type="checkbox"/> None of the above	P*		
* The WEEE symbol was printed on instruction manual only					

Prüfbericht - Nr.: <b>1431622388a 001</b>		Seite 4 von 7 Page 4 of 7	
Clause	Requirement	Remark	Verdict
<b>2</b>	<b>Product Design Article 4 2002/96/EC</b>		
	<b>Requirements</b>		
2.1	<b>Dismantling</b> Design features or manufacturing processes do not prevent product from being reused. The design and production of electrical and electronic equipment which take into account and facilitate dismantling and recovery, unless specific design features or manufacturing processes present overriding advantages, for example, with regard to the protection of the environment and / or safety requirements.	No rivets are used <input checked="" type="checkbox"/> Yes <input type="checkbox"/> No <input type="checkbox"/> N/A Fastening points are accessible, visible or clearly marked. <input checked="" type="checkbox"/> Yes <input type="checkbox"/> No <input type="checkbox"/> N/A Different chunks (metal, plastic) can easily be separated <input checked="" type="checkbox"/> Yes <input type="checkbox"/> No <input type="checkbox"/> N/A	P
2.2	<b>Materials identified and marked</b> All materials are marked with internationally recognised codes, especially polymers and other recyclable materials		
2.2.1	Hazardous materials and other toxic materials are identified	Identified on Bill of Material / Relevant Manual <input checked="" type="checkbox"/> Indicated <input type="checkbox"/> Not Indicated <input type="checkbox"/> N/A	P
2.2.2	All plastic parts greater than 25g marked to ISO 1043 and ISO 11469 indicating material category as PC, PE, ABS etc., and including additives, colour	Marked with coding on plastic parts <input type="checkbox"/> Indicated <input type="checkbox"/> Not Indicated <input checked="" type="checkbox"/> N/A	N
<b>3</b>	<b>Information for Users Article 10 2002/96/EC</b>		
3.1	<b>Requirements</b>		
3.1.1	The product accompanying documents e.g. User Manual, technical Documentation provide information about: a) The requirements not to dispose of WEEE as unsorted municipal waste and to collect such waste separately b) The meaning of the label above c) The effects on human health and environment as a result of the presence of hazardous substances d) The role of the user in contributing to reuse, recycling and other forms of recovery of WEEE e) Return and collection systems available to the user	Information provides in: <input checked="" type="checkbox"/> User Manual <input type="checkbox"/> Client's declaration letter	P

Prüfbericht - Nr.: Test Report No.:		1431622388a 001		Seite 5 von 7 Page 5 of 7	
Clause	Requirement	Remark		Verdict	
4	<b>Information for treatment Facilities Article 11 (1) 2002/96/EC</b>				
	<b>Requirements</b>				
4.1.	<b>Location of dangerous substances and preparations</b> Content and locations of dangerous substances and preparations are indicated in the accompanied documentation and information	Indication on the Bill of Material / Relevant Manual			
4.1.1	All fluids	<input type="checkbox"/> Indicated <input type="checkbox"/> Not indicated <input checked="" type="checkbox"/> N/A		N	
4.1.2	Polychlorinated biphenyls (PCB) containing capacitors in accordance with Council Directive 96/59/EC of 16 September 1996 on the disposal of polychlorinated biphenyls and polychlorinated terphenyls (PCB/PCT)	<input type="checkbox"/> Indicated <input type="checkbox"/> Not indicated <input checked="" type="checkbox"/> N/A		N	
4.1.3	Mercury containing components, such as switches or backlighting lamps	<input type="checkbox"/> Indicated <input type="checkbox"/> Not indicated <input checked="" type="checkbox"/> N/A		N	
4.1.4	Batteries, including batteries on printed circuit boards	<input checked="" type="checkbox"/> Indicated <input type="checkbox"/> Not indicated <input type="checkbox"/> N/A		P	
4.1.5	Printed circuit boards of mobile phones generally, and of other devices if the surface of the printed circuit board is greater than 10 square centimeters	<input type="checkbox"/> Indicated <input type="checkbox"/> Not indicated <input checked="" type="checkbox"/> N/A		N	
4.1.6	Toner cartridges, liquid and pasty, as well as colour toner	<input type="checkbox"/> Indicated <input type="checkbox"/> Not indicated <input checked="" type="checkbox"/> N/A		N	
4.1.7	Plastic containing brominated flame retardants	<input type="checkbox"/> Indicated <input type="checkbox"/> Not indicated <input checked="" type="checkbox"/> N/A		N	
4.1.8	Asbestos waste and components which contain asbestos	<input type="checkbox"/> Indicated <input type="checkbox"/> Not indicated <input checked="" type="checkbox"/> N/A		N	
4.1.9	Cathode ray tubes	<input type="checkbox"/> Indicated <input type="checkbox"/> Not indicated <input checked="" type="checkbox"/> N/A		N	

Prüfbericht - Nr.: <b>1431622388a 001</b>		Seite 6 von 7 Page 6 of 7	
Clause	Requirement	Remark	Verdict
<b>4</b>	<b>Information for treatment Facilities Article 11 (1) 2002/96/EC</b>		
4.1.10	Chlorofluorocarbons (CFC), hydrochlorofluorocarbons (HCFC) or hydrofluorocarbons (HFC), hydrocarbons (HC),	<input type="checkbox"/> Indicated <input type="checkbox"/> Not indicated <input checked="" type="checkbox"/> N/A	N
4.1.11	Gas discharge lamps	<input type="checkbox"/> Indicated <input type="checkbox"/> Not indicated <input checked="" type="checkbox"/> N/A	N
4.1.12	Liquid crystal displays (together with their casing where appropriate) of a surface greater than 100 square centimeters and all those back-lighted with gas discharge lamps	<input type="checkbox"/> Indicated <input type="checkbox"/> Not indicated <input checked="" type="checkbox"/> N/A	N
4.1.13	External electric cables	<input type="checkbox"/> Indicated <input type="checkbox"/> Not indicated <input checked="" type="checkbox"/> N/A	N
4.1.14	Components containing refractory ceramic fibres as described in Commission Directive 97/69/EC of 5 December 1997 adapting to technical progress Council Directive 67/548/EEC relating to the classification, packaging and labelling of dangerous substances	<input type="checkbox"/> Indicated <input type="checkbox"/> Not indicated <input checked="" type="checkbox"/> N/A	N
4.1.15	Components containing radioactive substances with the exception of components that are below the exemption thresholds set in Article 3 of and Annex I to Council Directive 96/29/Euratom of 13 May 1996 laying down basic safety standards for the protection of the health of workers and the general public against the dangers arising from ionising radiation	<input type="checkbox"/> Indicated <input type="checkbox"/> Not indicated <input checked="" type="checkbox"/> N/A	N
4.1.16	Electrolyte capacitors containing substances of concern (height > 25 mm, diameter > 25 mm or proportionately similar)	<input type="checkbox"/> Indicated <input type="checkbox"/> Not indicated <input checked="" type="checkbox"/> N/A	N
4.1.17	Other substances and preparations according to directives 67/548/EEC or Directive 1999/45/EC listed as dangerous	<input type="checkbox"/> Indicated <input type="checkbox"/> Not indicated <input checked="" type="checkbox"/> N/A	N

Prüfbericht - Nr.: Test Report No.:		<b>1431622388a 001</b>		Seite 7 von 7 Page 7 of 7	
Clause	Requirement	Remark		Verdict	
5	<b>Additional Information for recycling facilities about substances and materials impacting the recycling process in particular the metal smelting process included in parts and components others than Printed Circuit Boards</b>				
5.1	<b>Information about level B substances and materials according to Joint Industry Guide (Version April 2005)</b>				
5.1.1	Parts containing Beryllium (e.g. copper alloys) (Be), impacting the recycling process are clearly indicated or marked and can be easily removed	<input type="checkbox"/> Indicated / marked <input type="checkbox"/> Not indicated <input checked="" type="checkbox"/> N/A		N	
5.1.2	Parts containing Bismuth (Bi), impacting the recycling process are clearly indicated or marked and can be easily removed	<input type="checkbox"/> Indicated / marked <input type="checkbox"/> Not indicated <input checked="" type="checkbox"/> N/A		N	
5.1.3	Parts containing Antimony (Sb), impacting the recycling process are clearly indicated or marked and can be easily removed	<input type="checkbox"/> Indicated / marked <input type="checkbox"/> Not indicated <input checked="" type="checkbox"/> N/A		N	
<b>End of Report</b>					

**Prüfbericht - Nr.:** 143162388a 001  
*Test Report No.*

Seite 1 von 1  
*Page 1 of 1*

**Product name: Toy Gun (COBRA)**



Marking before rubbing

Marking after rubbing





**Exploded diagram**

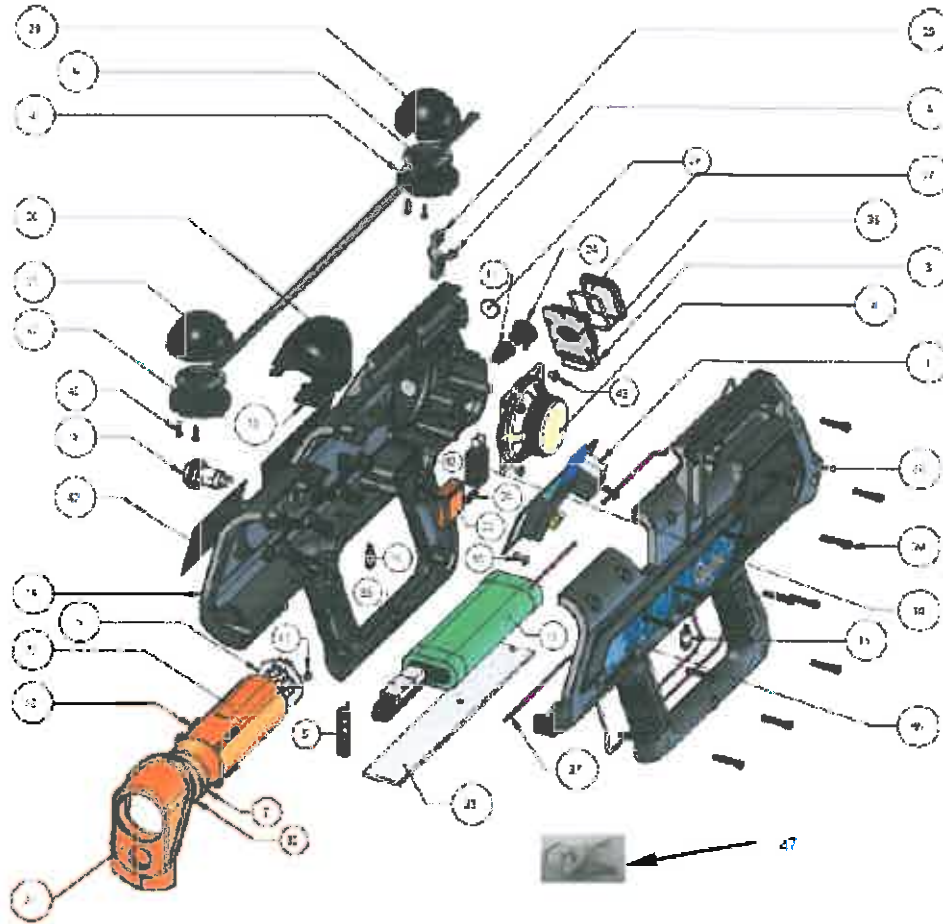

**Prüfbericht - Nr.:** 143162388a 001  
*Test Report No.*

Seite 2 von 3  
 Page 2 of 3

### Bill of Material

No.	Part Name	Material	Quantity	Remark
1	SATR Main Board		1	Type 1
2	Internal wires and plugs		1	Type 1
3	Liquid Crystal Display 4x16		1	Type 1
4	LED		1	Type 1
5	Internal Antenna		1	Type 1
6	Predator Muzzle Flash Board		1	
7	Optical Lens	Glass	1	Type 2
8	Speaker		1	Type 1
9	Head infrared Sensor including cable and 2 boards but not polycarbonate dome		1	Type 1
10	Infrared sensor that mounts inside main enclosure		1	Type 1
11	Direct Charge plug		1	Type 1
12	Charging Adapter suit DC Plug		1	Type 1
13	NIMH Battery		1	Type 2
14	Trigger electronic switch		1	Type 1
15	Left red button		1	Type 1
16	Right black button		1	Type 1
17	Antenna lead		1	Type 1
18	Key switch		1	Type 1
19	ENCLOSURE LEFT	PC Bayer Makrolon 2858	1	Type 3
20	ENCLOSURE RIGHT	PC Bayer Makrolon 2858	1	Type 3
21	MUZZLE	PC Bayer Makrolon 2858	1	Type 3
22	IR EMITTER BARREL	PC Bayer Makrolon 2858	1	Type 3
23	TRIGGER	PC Bayer Makrolon 2858	1	Type 3
24	RECHARGE DUST CAP	TPR Shore-A60	1	Type 3
25	REFLEX SIGHT LED/CABLE SUPPORT	TPR Shore-A60	1	Type 3
26	GUN MOUNTED SENSOR	PC Bayer Makrolon 2858	1	Type 3
27	LCD DISPLAY LENS	PC Bayer Makrolon 2858	1	Type 3

Prüfbericht - Nr.: 143162388a 001

Seite 3 von 3

Test Report No.

Page 3 of 3

No.	Part Name	Material	Quantity	Remark
28	REFLEX SIGHT LENS	Acrylic	2	Type 1
29	REAR HEAD SENSOR DOME	PC Bayer Makrolon 2858	1	Type 3
30	REAR HEAD SENSOR BASE	PC Bayer Makrolon 2858	1	Type 3
31	FRONT HEAD SENSOR DOME	PC Bayer Makrolon 2858	1	Type 3
32	FRONT HEAD SENSOR BASE	PC Bayer Makrolon 2858	1	Type 3
33	GROUNDING PLATE	5005 Aluminium	1	Type 3
34	TRIGGER SPRING	Stainless Steel	1	Type 3
35	MUZZLE LENS GASKET	TPR	1	Type 3
36	LCD LENS GASKET	TPR	1	Type 3
37	ENCLOSURE GASKET SET	TPR	1	Type 3
38	MOLD-IN, THRU THREADED INSERT	Brass	14	Type 2
39	SOCKET HEAD CAP SCREW M3 x 20mm	Stainless Steel	14	Type 3
40	PAN HEAD SELF-TAPPING SCREW 16mm	Stainless Steel	4	Type 3
41	PAN HEAD SELF-TAPPING SCREW 6.5mm	Stainless Steel	2	Type 3
42	MOLD-IN, THRU THREADED INSERT	Brass	4	Type 2
43	PAN HEAD MACHINE SCREW M3 x 5mm	Stainless Steel	4	Type 3
44	PAN HEAD SELF-TAPPING SCREW 9.5mm	Stainless Steel	2	Type 3
45	PAN HEAD SELF-TAPPING SCREW 9.5mm	Stainless Steel	8	Type 3
46	GRILL COVER LABEL SET	Lexan Polycarbonate	1	Type 1
47	Key	Non-ferrous metal (alloy)	1	Type 2

Type 1	Material / components which must be removed and treated separately
Type 2	Material / components which can disturb certain recycling processes
Type 3	Material / components through which benefits can be normally achieved